

NOTE: Fit U rubber before place bracket on the roof.

TMX RR 012 103972 B COVER

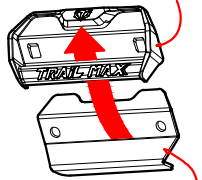

TMX RR 012 103972 B

59 M6 Plate nut X16

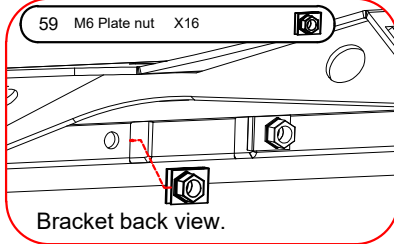

Bracket back view.

Bracket Fitment

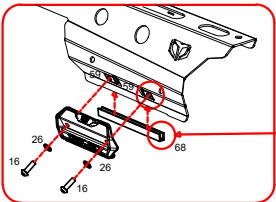
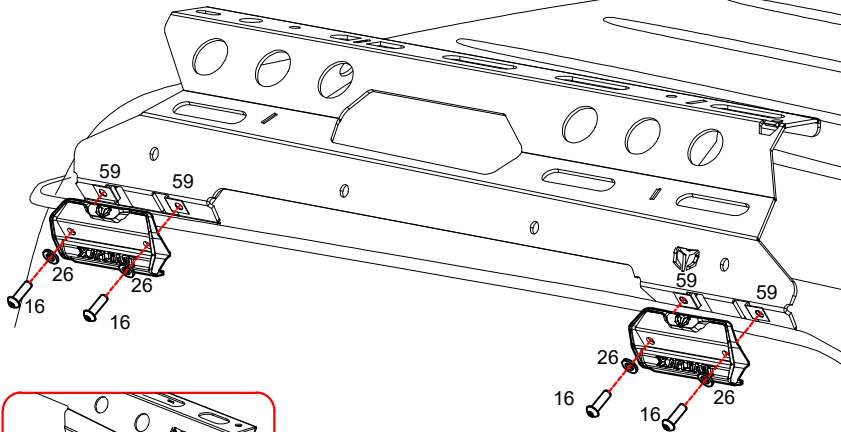

NOTE: Fit U rubber before place bracket on the roof.

- | | | | |
|----|--------------------|--|-----|
| 16 | M6 X 20 Allen Bolt | | X 8 |
| 26 | M6 Washer | | X 8 |
| 59 | M6 Plate nut | | X 8 |
| 31 | U Rubber | | X 4 |

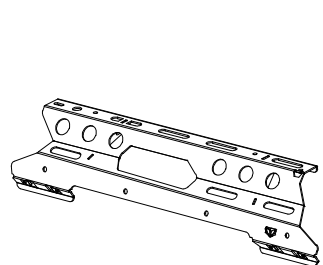

TMX RR 012 104060 LH-RH

TOYOTA LC 70S SC
104086



TMX RR 104060 BRACKET BOLT KIT

| Item N° | Part | Description | Qty |
|---------|---------------------------|-------------|-----|
| 19 | M8 x 25 Allen cap | | 8 |
| 22 | M8 washer | | 8 |
| 24 | M8 1.25 flange nylock nut | | 8 |
| 16 | M6 X 20 Allen bolt | | 8 |
| 26 | M6 washer | | 8 |
| 59 | M6 Plate nut | | 8 |
| 31 | U Rubber | | 4 |

- | | | | |
|----|----------------------|--|-----|
| 19 | M8 X 25 Allen Cap | | X 8 |
| 22 | M8 Washer | | X 8 |
| 24 | M8 Nylock Flange nut | | X 8 |

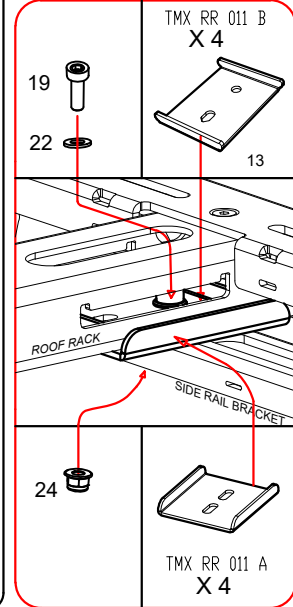
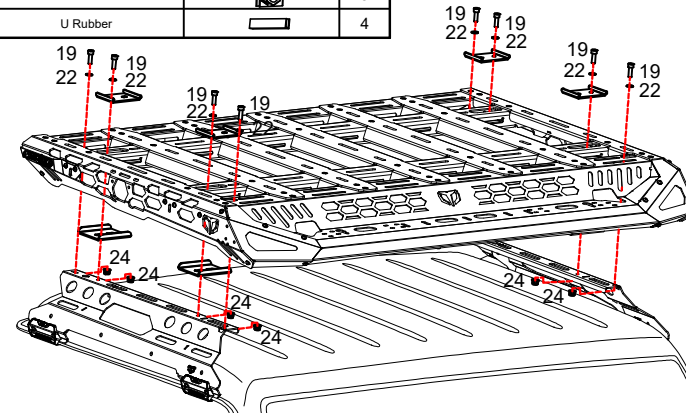

Tighten all M8 Allen cap bolts and M8 nuts using 6mm Allen key and 13mm Wrench.



DONE!

